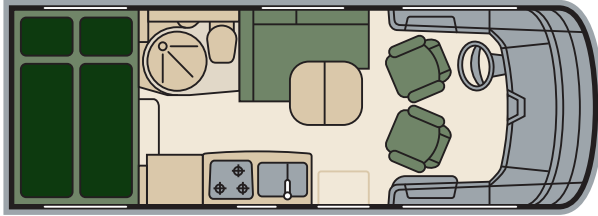

## Arto 64 GL

**NIESMANN  
+BISCHOFF**

2009

 A  
R  
T  
O

Arto 64 GL technical data

<b>basic vehicle</b>	<b>Fiat Ducato 35L</b>
chassis/frame	lowered Alko gauge chassis AMC
<b>engine</b>	
type	four cylinders Turbo Diesel Common Rail Direct
cubic capacity in cm <sup>3</sup>	2,300
power in kW/hp	95.5/130
maximum torque in Nm	320
gearbox	6 speed manual
<b>chassis/tyres</b>	
wheel base in mm	3,560
number of axles	2
tyre size	215/70 R 15
track front in mm	1,810
track rear in mm	1,860
<b>dimensions and weights [without equipment]</b>	
overall length in mm	6,674
overall width in mm	2,300
overall height in mm	2,950
turning circle (wall-wall) in m	approx. 13.5
admissible total mass in kg	3,500
weight when ready for driving in kg	3,020
admissible front axle load in kg	1,850
admissible rear axle load in kg	2,000
maximum loading capacity in kg	480
trailer load unbraked in kg	750
admissible trailer load braked in kg	2,000
<b>living room</b>	
interior width in mm	2,180
interior height in mm	1,980
<b>seats</b>	
seats with three-point safety belt	4
L-shaped sofa (length x width) in mm	1,413 x 1,204
individual seater (length x width) in mm	-
<b>beds</b>	
folding bed (length x width) in mm	1,910 x 1,290
rear bed (length x width) in mm	2,000 x 1,350
<b>filling quantities</b>	
fuel tank in litre	90
water tank in litre	20/100
waste water tank in litre	100
sewage (cassette) in litre	17
gas in kg	2 x 11
<b>garage dimensions and flap clearance</b>	
maximum floor space (length x width) in mm	2,038 x 1,135
maximum garage height in mm	1,185
maximum usable space (length x width) in mm	2,160 x 1,385
flap clearance (width x height) in mm	920 x 1,040
<b>price net in Euro without VAT</b>	<b>63,016.81</b>

## Arto 64 L

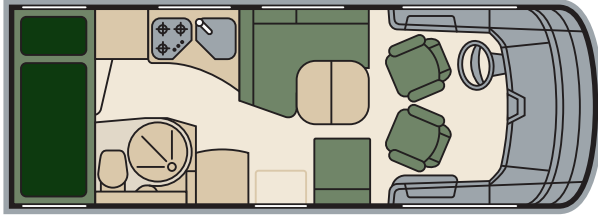
**NIESMANN  
+BISCHOFF**

2009

 A  
R  
T  
O

Arto 64 L technical data

<b>basic vehicle</b>	<b>Fiat Ducato 35L</b>
chassis/frame	lowered Alko gauge chassis AMC
<b>engine</b>	
type	four cylinders Turbo Diesel Common Rail Direct
cubic capacity in cm <sup>3</sup>	2,300
power in kW/hp	95.5/130
maximum torque in Nm	320
gearbox	6 speed manual
<b>chassis/tyres</b>	
wheel base in mm	3,560
number of axles	2
tyre size	215/70 R 15
track front in mm	1,810
track rear in mm	1,860
<b>dimensions and weights [without equipment]</b>	
overall length in mm	6,674
overall width in mm	2,300
overall height in mm	2,950
turning circle (wall-wall) in m	approx. 13.5
admissible total mass in kg	3,500
weight when ready for driving in kg	3,050
admissible front axle load in kg	1,850
admissible rear axle load in kg	2,000
maximum loading capacity in kg	450
trailer load unbraked in kg	750
admissible trailer load braked in kg	2,000
<b>living room</b>	
interior width in mm	2,180
interior height in mm	1,980
<b>seats</b>	
seats with three-point safety belt	4
L-shaped sofa (length x width) in mm	1,413 x 1,204
individual seater (length x width) in mm	703 x 620
<b>beds</b>	
folding bed (length x width) in mm	1,910 x 1,290
rear bed (length x width) in mm	2,000 x 850
<b>filling quantities</b>	
fuel tank in litre	90
water tank in litre	20/100
waste water tank in litre	100
sewage (cassette) in litre	17
gas in kg	2 x 11
<b>garage dimensions and flap clearance</b>	
maximum floor space (length x width) in mm	2,038 x 885
maximum garage height in mm	1,185
maximum usable space (length x width) in mm	2,160 x 885
flap clearance (width x height) in mm	700 x 1,020
<b>price net in Euro without VAT</b>	<b>63,016.81</b>

# Arto 69 EL

**NIESMANN  
+BISCHOFF**

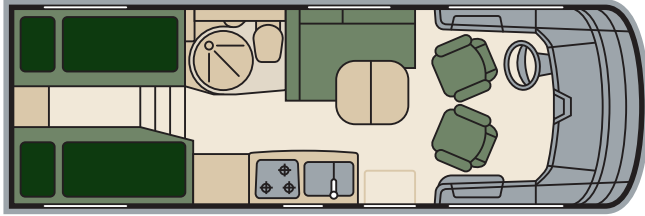

2009

ARTO

Arto 69 EL technical data

<b>basic vehicle</b>	<b>Fiat Ducato 35L</b>
chassis/frame	lowered Alko gauge chassis AMC
<b>engine</b>	
type	four cylinders Turbo Diesel Common Rail Direct
cubic capacity in cm <sup>3</sup>	2,300
power in kW/hp	95.5/130
maximum torque in Nm	320
gearbox	6 speed manual
<b>chassis/tyres</b>	
wheel base in mm	3,810
number of axles	2
tyre size	215/70 R 15
track front in mm	1,810
track rear in mm	1,860
<b>dimensions and weights [without equipment]</b>	
overall length in mm	7,174
overall width in mm	2,300
overall height in mm	2,950
turning circle (wall-wall) in m	approx. 14.5
admissible total mass in kg	3,500
weight when ready for driving in kg	3,120
admissible front axle load in kg	1,850
admissible rear axle load in kg	2,000
maximum loading capacity in kg	380
trailer load unbraked in kg	750
admissible trailer load braked in kg	2,000
<b>living room</b>	
interior width in mm	2,180
interior height in mm	1,980
<b>seats</b>	
seats with three-point safety belt	4
L-shaped sofa (length x width) in mm	1,413 x 1,204
individual seater (length x width) in mm	-
<b>beds</b>	
folding bed (length x width) in mm	1,910 x 1,290
rear bed (length x width) in mm	1,870/1,930 x 760
<b>filling quantities</b>	
fuel tank in litre	90
water tank in litre	20/100
waste water tank in litre	100
sewage (cassette) in litre	17
gas in kg	2 x 11
<b>garage dimensions and flap clearance</b>	
maximum floor space (length x width) in mm	2,038 x 1,135
maximum garage height in mm	1,185
maximum usable space (length x width) in mm	2,160 x 1,385
flap clearance (width x height) in mm	920 x 1,040
<b>price net in Euro without VAT</b>	<b>66,378.15</b>

## Arto 69 L

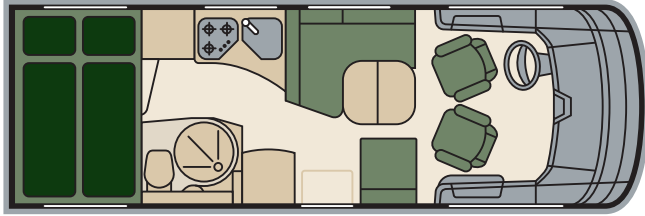
**NIESMANN  
+BISCHOFF**

2009

 A  
R  
T  
O

Arto 69 L technical data

<b>basic vehicle</b>	<b>Fiat Ducato 35L</b>
chassis/frame	lowered Alko gauge chassis AMC
<b>engine</b>	
type	four cylinders Turbo Diesel Common Rail Direct
cubic capacity in cm <sup>3</sup>	2,300
power in kW/hp	95.5/130
maximum torque in Nm	320
gearbox	6 speed manual
<b>chassis/tyres</b>	
wheel base in mm	3,810
number of axles	2
tyre size	215/70 R 15
track front in mm	1,810
track rear in mm	1,860
<b>dimensions and weights [without equipment]</b>	
overall length in mm	7,174
overall width in mm	2,300
overall height in mm	2,950
turning circle (wall-wall) in m	approx. 14.5
admissible total mass in kg	3,500
weight when ready for driving in kg	3,150
admissible front axle load in kg	1,850
admissible rear axle load in kg	2,000
maximum loading capacity in kg	350
trailer load unbraked in kg	750
admissible trailer load braked in kg	2,000
<b>living room</b>	
interior width in mm	2,180
interior height in mm	1,980
<b>seats</b>	
seats with three-point safety belt	4
L-shaped sofa (length x width) in mm	1,413 x 1,204
individual seater (length x width) in mm	703 x 620
<b>beds</b>	
folding bed (length x width) in mm	1,910 x 1,290
rear bed (length x width) in mm	2,000 x 1,350
<b>filling quantities</b>	
fuel tank in litre	90
water tank in litre	20/100
waste water tank in litre	100
sewage (cassette) in litre	17
gas in kg	2 x 11
<b>garage dimensions and flap clearance</b>	
maximum floor space (length x width) in mm	2,038 x 1,135
maximum garage height in mm	1,185
maximum usable space (length x width) in mm	2,160 x 1,385
flap clearance (width x height) in mm	920 x 1,040
<b>price net in Euro without VAT</b>	<b>66,378.15</b>

# Arto 69 PL

**NIESMANN  
+BISCHOFF**

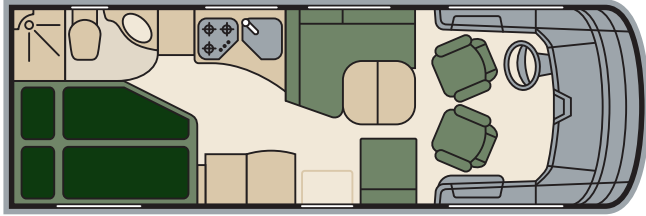

2009

ARTO

Arto 69 PL technical data

<b>basic vehicle</b>	<b>Fiat Ducato 35L</b>
chassis/frame	lowered Alko gauge chassis AMC
<b>engine</b>	
type	four cylinders Turbo Diesel Common Rail Direct
cubic capacity in cm <sup>3</sup>	2,300
power in kW/hp	95.5/130
maximum torque in Nm	320
gearbox	6 speed manual
<b>chassis/tyres</b>	
wheel base in mm	3,810
number of axles	2
tyre size	215/70 R 15
track front in mm	1,810
track rear in mm	1,860
<b>dimensions and weights</b> [without equipment]	
overall length in mm	7,171
overall width in mm	2,300
overall height in mm	2,950
turning circle (wall-wall) in m	approx. 14.5
admissible total mass in kg	3,500
weight when ready for driving in kg	3,090
admissible front axle load in kg	1,850
admissible rear axle load in kg	2,000
maximum loading capacity in kg	410
trailer load unbraked in kg	750
admissible trailer load braked in kg	2,000
<b>living room</b>	
interior width in mm	2,180
interior height in mm	1,980
<b>seats</b>	
seats with three-point safety belt	4
L-shaped sofa (length x width) in mm	1,413 x 1,204
individual seater (length x width) in mm	703 x 620
<b>beds</b>	
folding bed (length x width) in mm	1,910 x 1,290
rear bed (length x width) in mm	1,990 x 1,340/920
<b>filling quantities</b>	
fuel tank in litre	90
water tank in litre	20/100
waste water tank in litre	100
sewage (cassette) in litre	17
gas in kg	2 x 11
<b>garage dimensions and flap clearance</b>	
maximum floor space (length x width) in mm	2,038 x 1,135
maximum garage height in mm	890
maximum usable space (length x width) in mm	1,250 x 1,135
flap clearance (width x height) in mm	800 x 740
<b>price</b> net in Euro without VAT	<b>66,378.15</b>

# Arto 74 L

**NIESMANN  
+BISCHOFF**

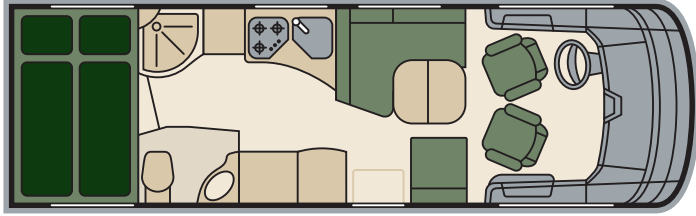

2009

ARTO

Arto 74 L technical data

<b>basic vehicle</b>	<b>Fiat Ducato 40H</b>
chassis/frame	lowered Alko gauge chassis MC 50 HT
<b>engine</b>	
type	four cylinders Turbo Diesel Common Rail Direct
cubic capacity in cm <sup>3</sup>	2,300
power in kW/hp	95.5/130
maximum torque in Nm	320
gearbox	6 speed manual
<b>chassis/tyres</b>	
wheel base in mm	3,710 + 800
number of axles	3
tyre size	225/75 R 16
track front in mm	1,810
track rear in mm	1,860
<b>dimensions and weights [without equipment]</b>	
overall length in mm	7,774
overall width in mm	2,300
overall height in mm	2,950
turning circle (wall-wall) in m	approx. 14.9
admissible total mass in kg	5,000
weight when ready for driving in kg	3,370
admissible front axle load in kg	2,100
admissible rear axle load in kg	2 x 1,500
maximum loading capacity in kg	1,630
trailer load unbraked in kg	750
admissible trailer load braked in kg	2,000
<b>living room</b>	
interior width in mm	2,180
interior height in mm	1,980
<b>seats</b>	
seats with three-point safety belt	4
L-shaped sofa (length x width) in mm	1,413 x 1,204
individual seater (length x width) in mm	703 x 620
<b>beds</b>	
folding bed (length x width) in mm	1,910 x 1,290
rear bed (length x width) in mm	2,000 x 1,350
<b>filling quantities</b>	
fuel tank in litre	90
water tank in litre	20/100
waste water tank in litre	100
sewage (cassette) in litre	17
gas in kg	2 x 11
<b>garage dimensions and flap clearance</b>	
maximum floor space (length x width) in mm	2,038 x 1,135
maximum garage height in mm	1,185
maximum usable space (length x width) in mm	2,160 x 1,385
flap clearance (width x height) in mm	920 x 1,040
<b>price net in Euro without VAT</b>	<b>75,621.85</b>

# Arto 74 LE

**NIESMANN  
+BISCHOFF**

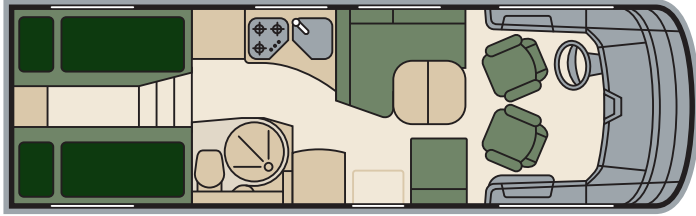

2009

ARTO

Arto 74 LE technical data

<b>basic vehicle</b>	<b>Fiat Ducato 40H</b>
chassis/frame	lowered Alko gauge chassis MC 50 HT
<b>engine</b>	
type	four cylinders Turbo Diesel Common Rail Direct
cubic capacity in cm <sup>3</sup>	2,300
power in kW/hp	95.5/130
maximum torque in Nm	320
gearbox	6 speed manual
<b>chassis/tyres</b>	
wheel base in mm	3,710 + 800
number of axles	3
tyre size	225/75 R 16
track front in mm	1,810
track rear in mm	1,860
<b>dimensions and weights [without equipment]</b>	
overall length in mm	7,774
overall width in mm	2,300
overall height in mm	2,950
turning circle (wall-wall) in m	approx. 14.9
admissible total mass in kg	5,000
weight when ready for driving in kg	3,380
admissible front axle load in kg	2,100
admissible rear axle load in kg	2 x 1,500
maximum loading capacity in kg	1,620
trailer load unbraked in kg	750
admissible trailer load braked in kg	2,000
<b>living room</b>	
interior width in mm	2,180
interior height in mm	1,980
<b>seats</b>	
seats with three-point safety belt	4
L-shaped sofa (length x width) in mm	1,413 x 1,204
individual seater (length x width) in mm	703 x 620
<b>beds</b>	
folding bed (length x width) in mm	1,910 x 1,290
rear bed (length x width) in mm	1,950/1,970 x 760
<b>filling quantities</b>	
fuel tank in litre	90
water tank in litre	20/100
waste water tank in litre	100
sewage (cassette) in litre	17
gas in kg	2 x 11
<b>garage dimensions and flap clearance</b>	
maximum floor space (length x width) in mm	2,038 x 1,135
maximum garage height in mm	1,185
maximum usable space (length x width) in mm	2,160 x 1,385
flap clearance (width x height) in mm	920 x 1,040
<b>price net in Euro without VAT</b>	<b>75,621.85</b>